



SOLATUBE®

DAYLIGHTING SYSTEMS

Installation Instructions

Solatube Ø 74 cm round
Double roof dome

Enjoy daylight

Contents

1. Product Overview.....	4
1.1 Parts	4
2. Installation Steps	5
2.1 Step 1 – Fit the curb cap	5
2.2 Step 2 – Remove protective film	5
2.3 Step 3 – Bend out tube tabs	6
2.4 Step 4 – Assemble the tube	7
2.5 Step 5 – Install tube	7
2.6 Step 6 – Fit the tube belt	8
2.7 Step 7 – Lock the tube belt	9
2.8 Step 8 – Fit prismatic diffuser	9
2.9 Step 9 – Install the system	10
2.10 Step 10 – Screw fix the curb cap	11

Version

20-08-2020

Safety Information

- Always observe the safety instructions for the materials and tools to be used.
- Always wear the appropriate personal protective equipment (gloves, safety goggles etc.)
- We would suggest that any roof works is completed by an experienced roofer.
- Always have any electrical works carried out by a certified electrician.
- Please note that the installation works is carried out at your own risk.

Guarantee

Non-electrical Solatube® components are covered by a 10 year manufacturer's warranty against any manufacturing defects. Please retain the original proof of purchase to validate the product warranty. Any costs associated to the installation of any replacement parts covered under the warranty remain at the expense of the purchaser. Our terms and conditions are available upon request.

Disclaimer

Techcomlight Limited expressly disclaims any liability for any unexpected additional expense arising as a result of condensation or any water damage resulting from condensation, installation not in accordance with Techcomlight Limited's installation guide/s or any other external influences beyond the control of Techcomlight Limited. Techcomlight cannot be held liable for damage to structures caused as a result of making openings and installing Solatube® systems. Techcomlight assumes no responsibility or obligation for the failure of an architect, contractor, installer or building owner to comply with all applicable laws, ordinances, building codes, energy codes, fire and safety codes and requirements, and adequate safety measures.

Installation instructions reserved. No rights can be derived from this publication.

1. Product Overview



1.1 Parts

- 1. Curb cap
- 2. 610 mm tube
- 3. Tube belt
- 4. Pop rivets

2. Installation Steps

2.1 Step 1 – Fit the curb cap

Determine where you want to install the Solatube from the inside and mark the position through the roof.

Note: Consider the roof construction and any electrical wires or pipes which may be hidden within the roof void.

Create a circular opening through the roof construction with a diameter of 749mm.

Create a square curb around the opening as shown below. Ensure that the curb is appropriately 'weathered' to the roof and is watertight.

Note: The curb (formwork) is not supplied as standard and can be constructed by yourself or requested from Techcomlight at an additional cost. The curb can be constructed from either wood or metal.

Formwork dimensions (Curb): Curb dimensions: 873 mm x 873 mm so that enough space remains for the roof covering. Curb height: 191 mm minimum.

Place the curb cap upside down (with the dome down) onto the curb. This must be done so that the final assembly of the Ø 74 cm can take place without damaging the dome.

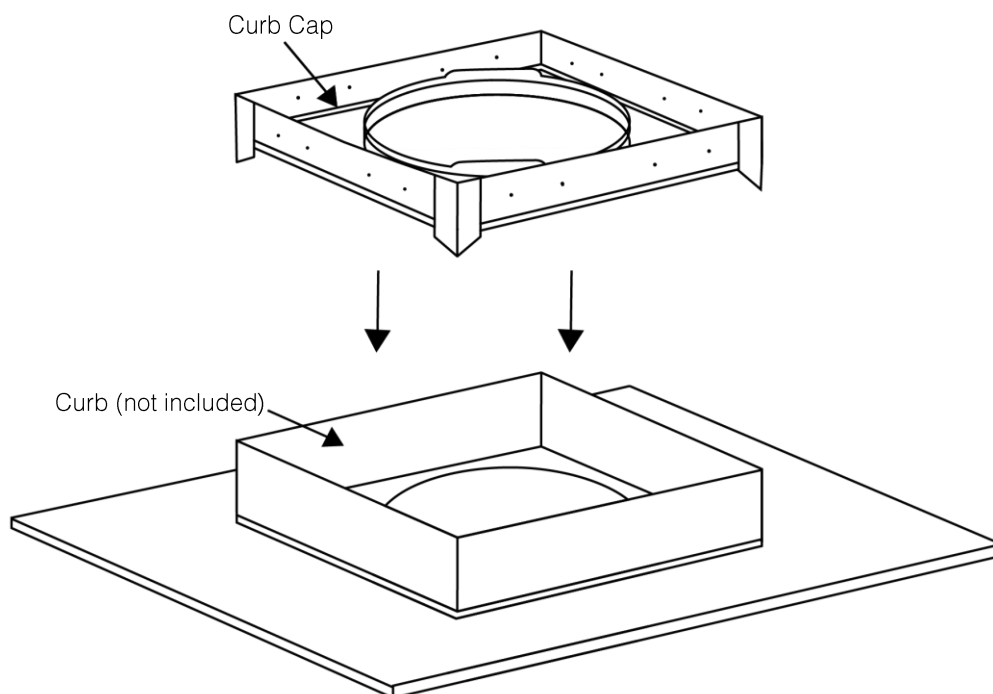

2.2 Step 2 – Remove protective film

Remove the protective film from the inside of the tube.

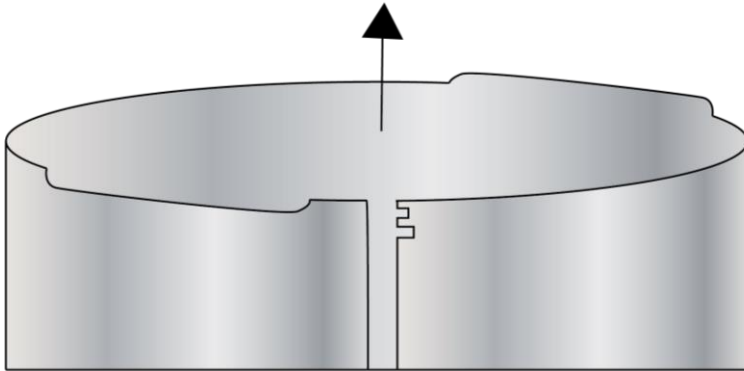

2.3 Step 3 – Bend out tube tabs

Bend the tube tabs out at a 90 degree angle. The Tube strap will locate down onto these later.

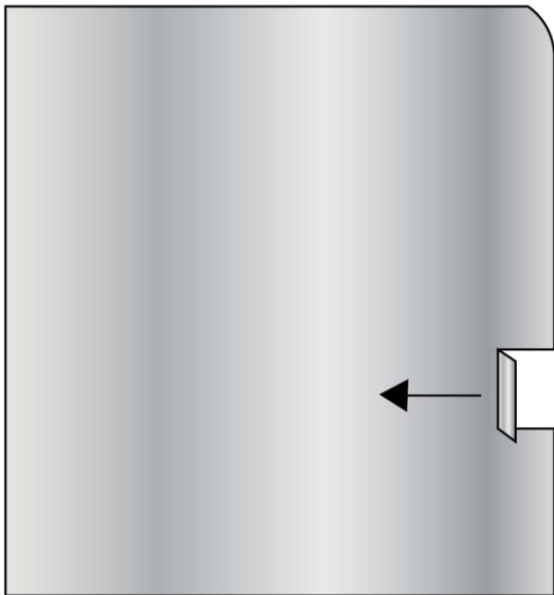

2.4 Step 4 – Assemble the tube

Assemble the tube and use the rivets to secure it together as shown below.

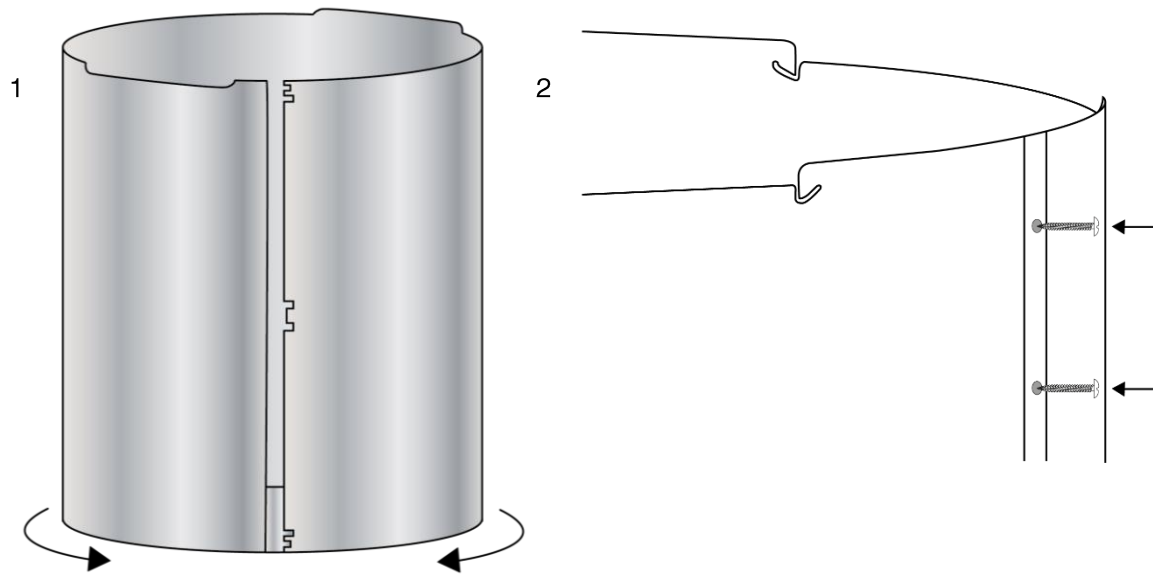

2.5 Step 5 – Install tube

Align the tube with the connecting ring on the curb cap, make sure that the long tube seam is opposite to the seam of the curb cap.

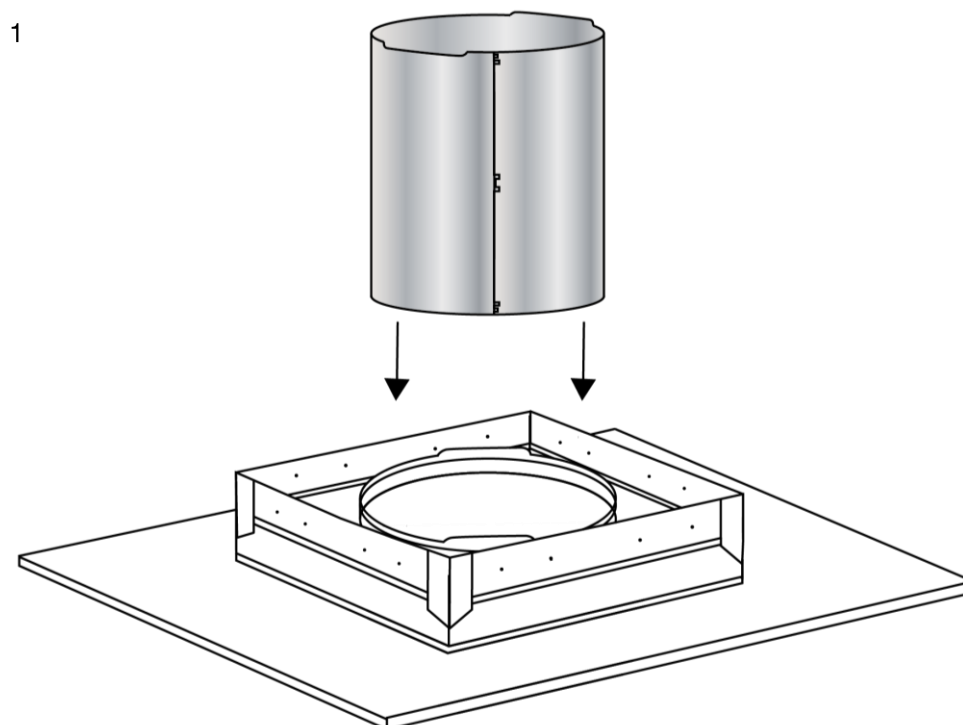

Connect the tube to the ring with the interlocking connecting clips as shown below.

Note: Make sure these are all securely connected.

Then tape the seam with the aluminium tape supplied.

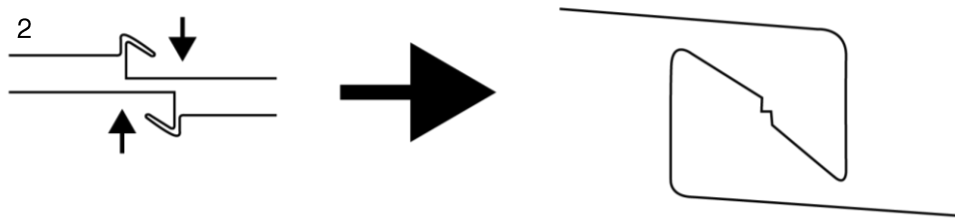

2.6 Step 6 – Fit the tube belt

Hook the tube strap together and lower it down over the tube until it rests between the bent tabs.

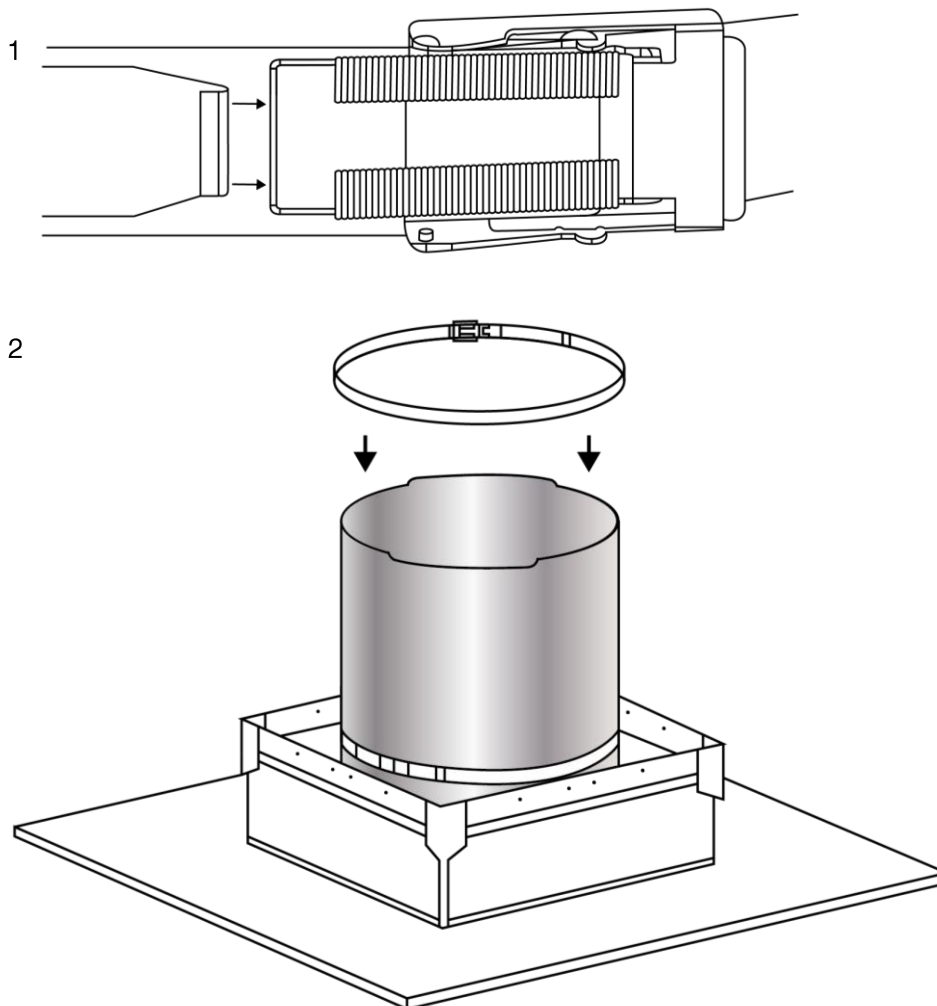

2.7 Step 7 – Lock the tube belt

When the belt is in the correct position it can be secured in place by closing the belt latch. Press firmly on the latch to lock it.

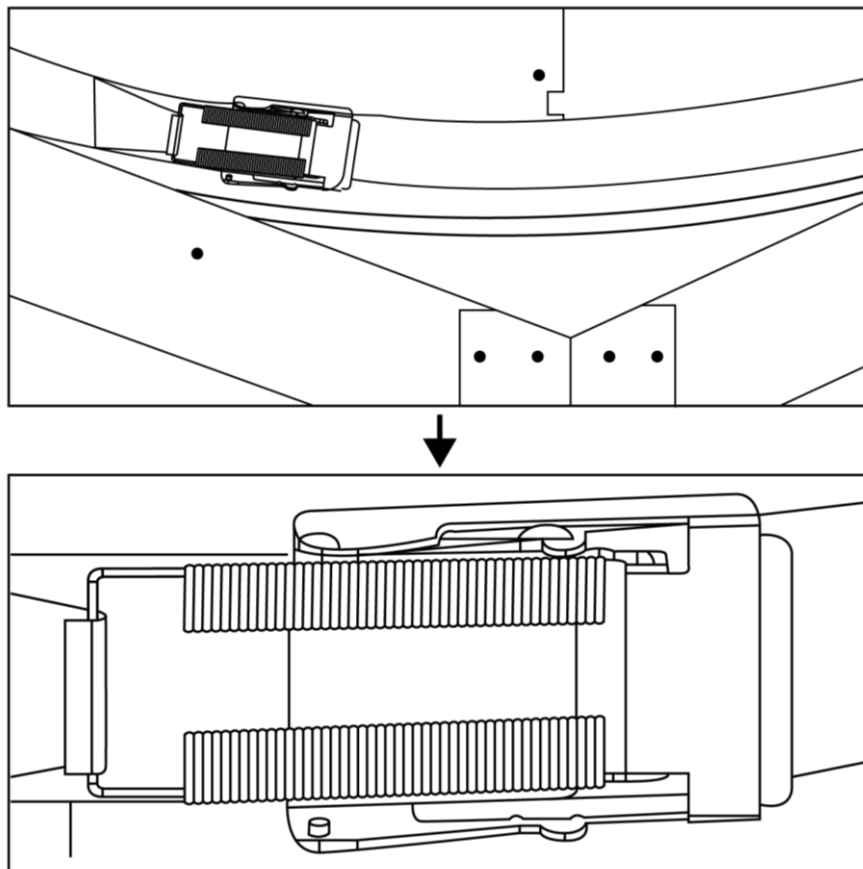

2.8 Step 8 – Fit prismatic diffuser

The next step is to fit the diffuser. See the installation instructions for the Prismatic diffuser available from our website - www.solatube.uk.

Note: If the Amplifier and Prismatic diffuser is chosen, the amplifier will need to be installed before the diffuser.

2.9 Step 9 – Install the system

Lift the assembled system as a whole and turn it 180 degrees. Lower the whole system down through the curb until the curb cap fits down onto the curb.

1

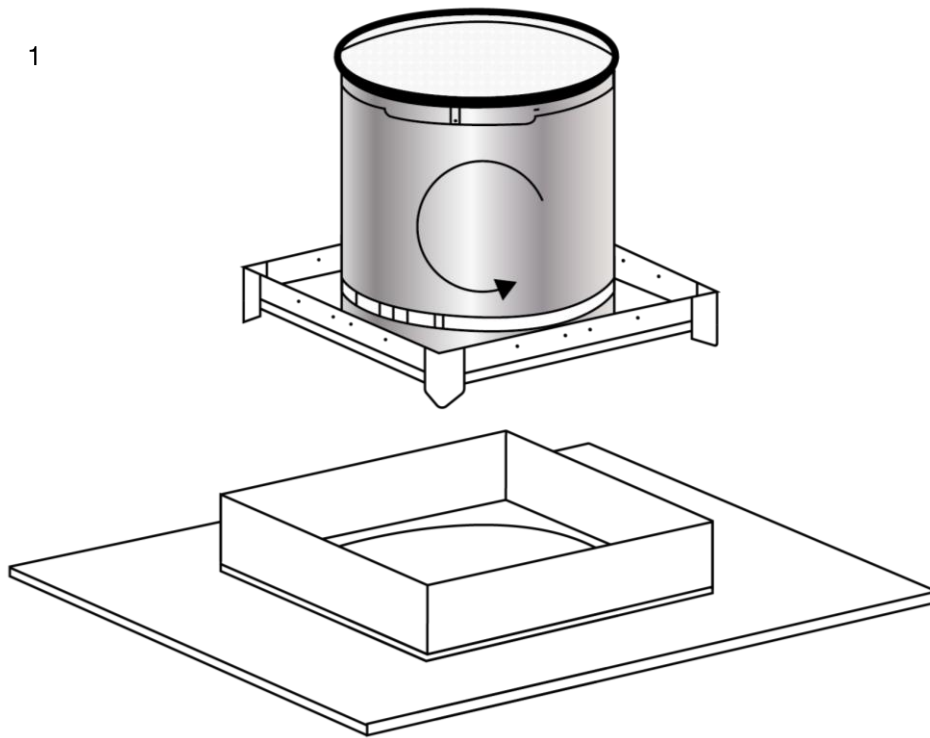

2

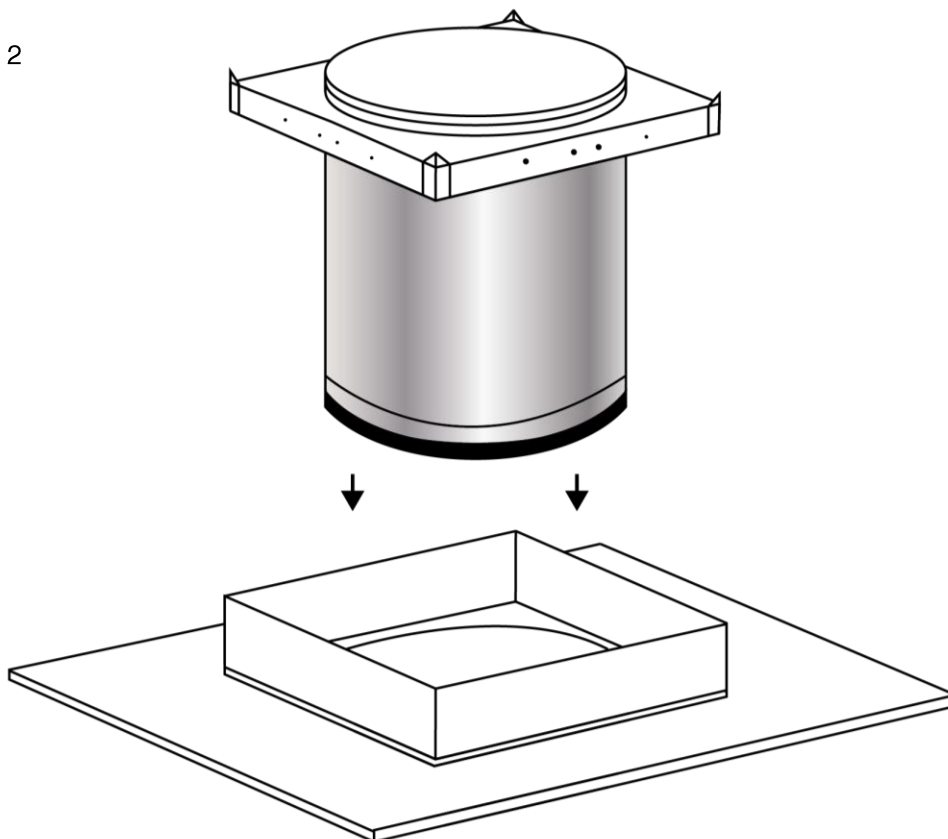

2.10 Step 10 – Screw fix the curb cap

Screw the curb cap onto the curb, with 4 screws per side, 16 in total.

Note: These screws are not included.

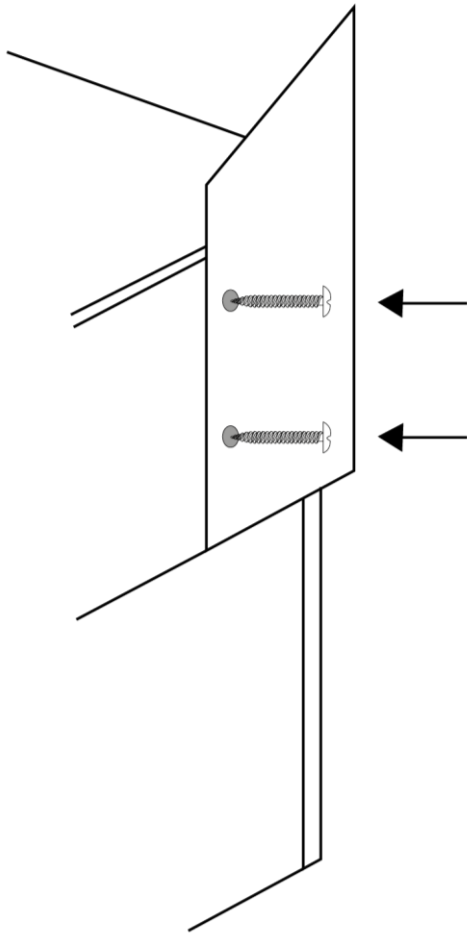

This completes the installation of the Solatube.

