



SOLATUBE®

DAYLIGHTING SYSTEMS



Installation Instructions

Solatube Ø 25 cm

0-90° adjustable angle extension tubes

Enjoy daylight

Contents

1.1 Parts	3
2. Installation Steps	4
2.1 Step 1 – Apply the brush sealing strip	4
2.2 Step 2 – Set the angle	4
2.3 Step 3 – Install extension tubes	5

Version

12-08-2020

Safety Information

- Always observe the safety instructions for the materials and tools to be used.
- Always wear the appropriate personal protective equipment (gloves, safety goggles etc.)
- We would suggest that any roof works is completed by an experienced roofer.
- Always have any electrical works carried out by a certified electrician.
- Please note that the installation works is carried out at your own risk.

Guarantee

Non-electrical Solatube® components are covered by a 10 year manufacturer's warranty against any manufacturing defects. Please retain the original proof of purchase to validate the product warranty. Any costs associated to the installation of any replacement parts covered under the warranty remain at the expense of the purchaser. Our terms and conditions are available upon request.

Disclaimer

Techcomlight Limited expressly disclaims any liability for any unexpected additional expense arising as a result of condensation or any water damage resulting from condensation, installation not in accordance with Techcomlight Limited's installation guide/s or any other external influences beyond the control of Techcomlight Limited. Techcomlight cannot be held liable for damage to structures caused as a result of making openings and installing Solatube® systems. Techcomlight assumes no responsibility or obligation for the failure of an architect, contractor, installer or building owner to comply with all applicable laws, ordinances, building codes, energy codes, fire and safety codes and requirements, and adequate safety measures. Installation instructions reserved. No rights can be derived from this publication.

1. Product Overview

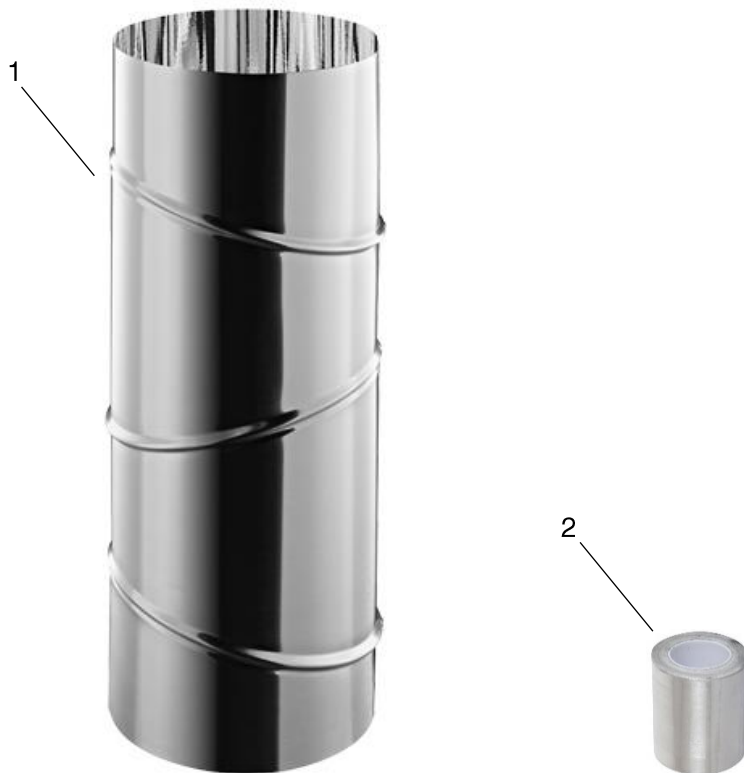

1.1 Parts

1. 0-90° Adjustable angle
2. Roll of aluminium tape

2. Installation Steps

2.1 Step 1 – Apply the brush sealing strip

Stick the brush seal strip around the outside of the 0-30° adjustable angle, just below the top of the tube as shown below. Using the entire sealing strip, wrap the strip around the tube keeping the rings tightly together as shown.

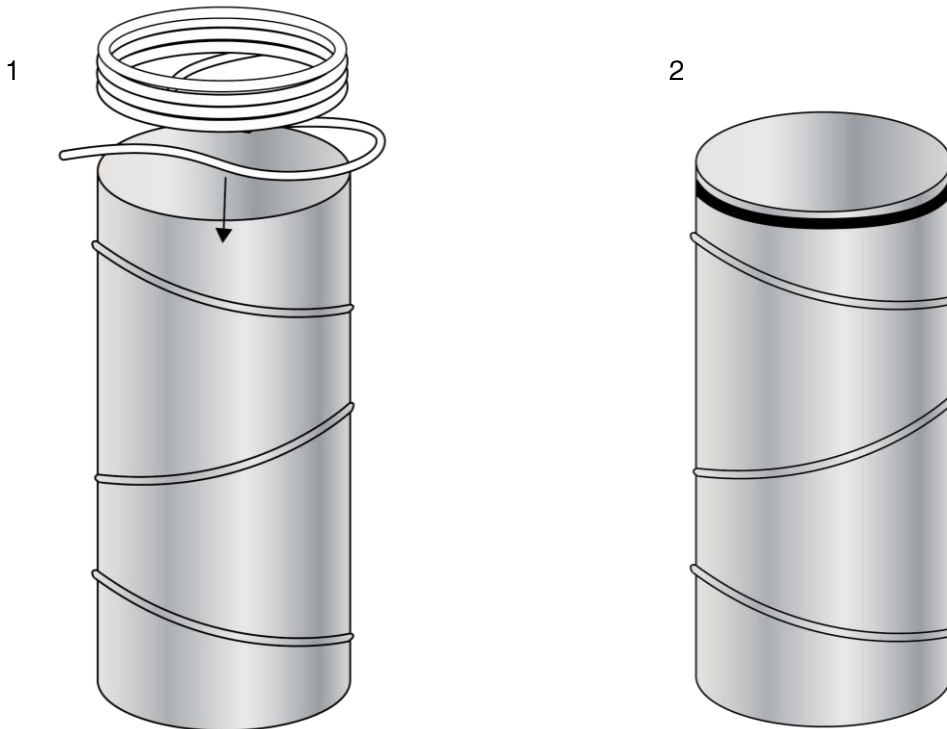

2.2 Step 2 – Set the angle

How to adjust the integral angle: Carefully peel back the protective film inside the tube from along the angle seam.

Grasp the top tube with two hands, just below the adjustable angle seam (diagonal). Use your thumbs and index fingers to rotate the angle section as required.

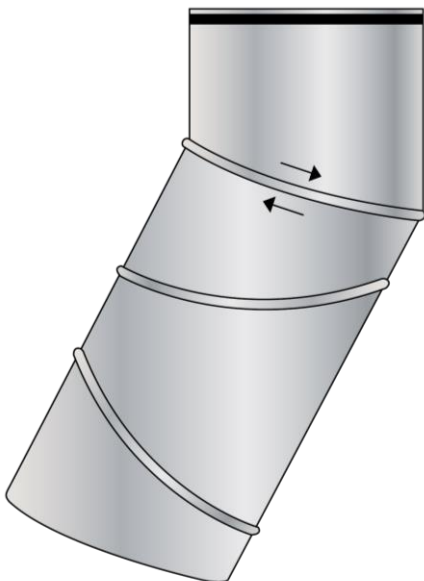

2.3 Step 3 – Install extension tubes

This instruction assumes that the void between the roof and ceiling is not accessible. If you can access the roof void it may be easier to do so to connect the and install the extension tubes.

The Solatube extension tubes are designed to be slightly conical when assembled: the diameter of the top of the tube is larger than the bottom, therefore the top of the extension tube fits up over the bottom of the tube above and the bottom of the extension tubes fits down into the top of the tube below.

Note: With lightweight ceiling systems and/or a long Solatube system (multiple extension tubes), it is advisable to reinforce the ceiling and/or add suspension wires up to the roof construction to support the system.

Remember to tape all external tube seams carefully with the aluminum tape supplied, to include:

- Adjustable angles
- Vertical long tube seams
- Horizontal tube connection seams

Slide the 0-90° extension tube down into the tube section below. Overlap the extensions by at least 25 mm.

Tape the external seams all around with the aluminum tape on the outside of the tube. If necessary, use two screws to secure the tubes together.

Tip: If required, the tube sections can be shortened with the use of a pair of tin snips.

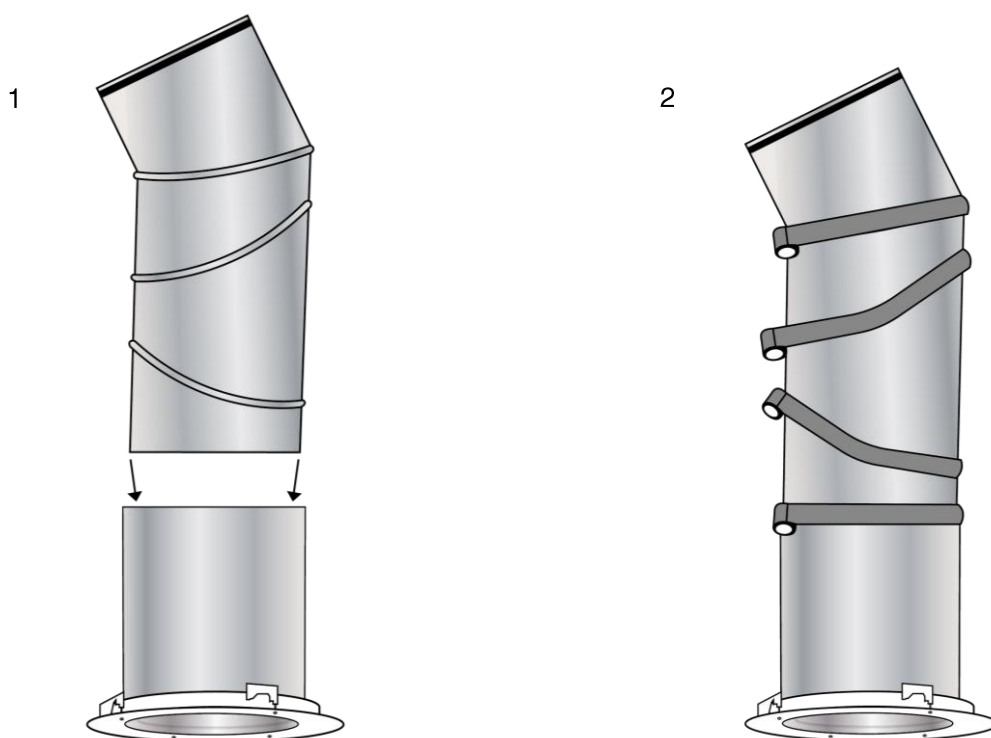

Slide the tube up through the ceiling opening from below.
Push the end with the brush seal up into the top tube assembly.

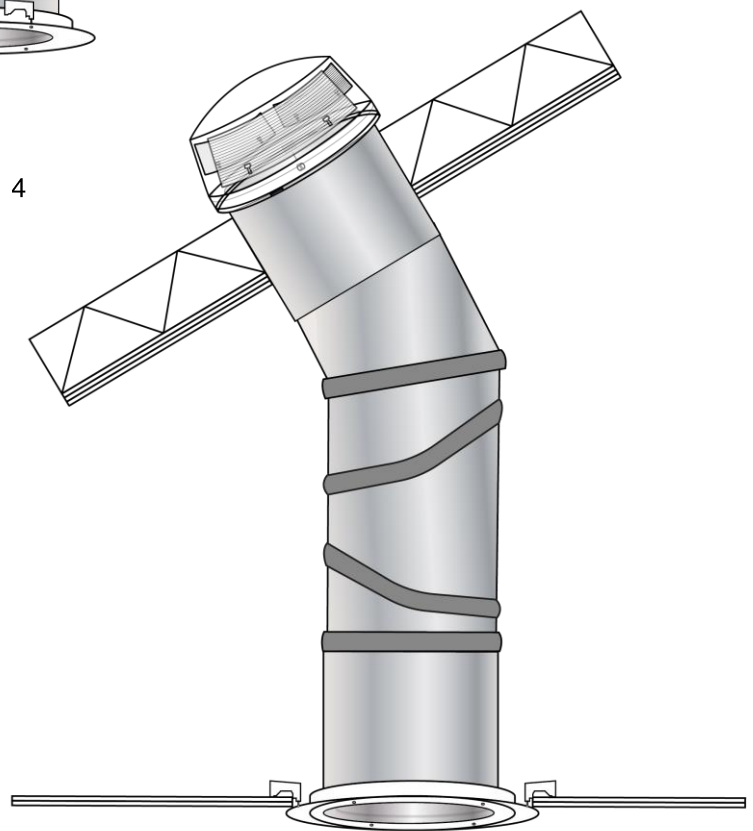
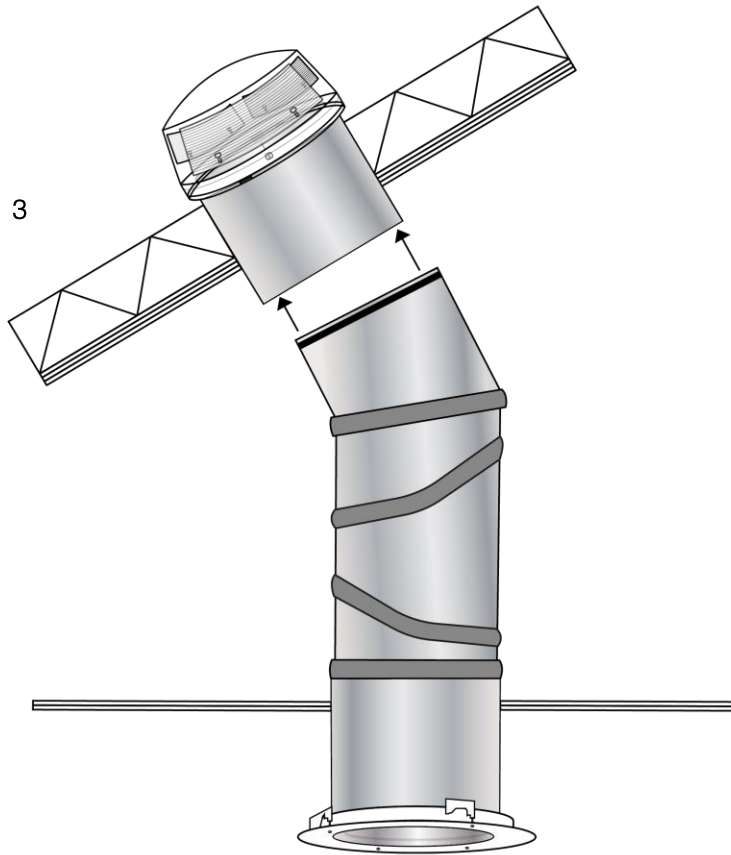

This completes the installation of the 0-30° adjustable angle/s.



Techcomlight is distributeur van Solatube Benelux

www.solatube.nl | www.techcomlight.nl
www.solatube.be | www.techcomlight.be